

Albert Street watermain installation from Fisher Street to Albany Street

As early as April 21, 2025 - July 31, 2025
Monday to Friday, 7:00AM - 7:00PM

Project Overview

The Bowmanville Extension will extend Lakeshore East GO rail service nearly 20-kilometres east of the Durham College Oshawa GO Station to Bowmanville, serving the Region of Durham. Expanded rail service will provide Durham Region with direct connections to the larger GO Transit network, helping to reduce congestion in the Greater Golden Horseshoe while better connecting customers to education, family, entertainment and jobs.

What is happening?

Beginning in April 2025 as part of early preparatory work for the Bowmanville Extension, a new watermain will be installed across the corridor at Albert Street to replace the section of watermain crossing the corridor at Simcoe Street that is being removed as part of the project. The new watermain will be installed across the corridor, under the existing railway tracks using trenchless installation. Open-cut trenching will follow to tie the new watermain into the existing system at Fisher Street and Albany Street.

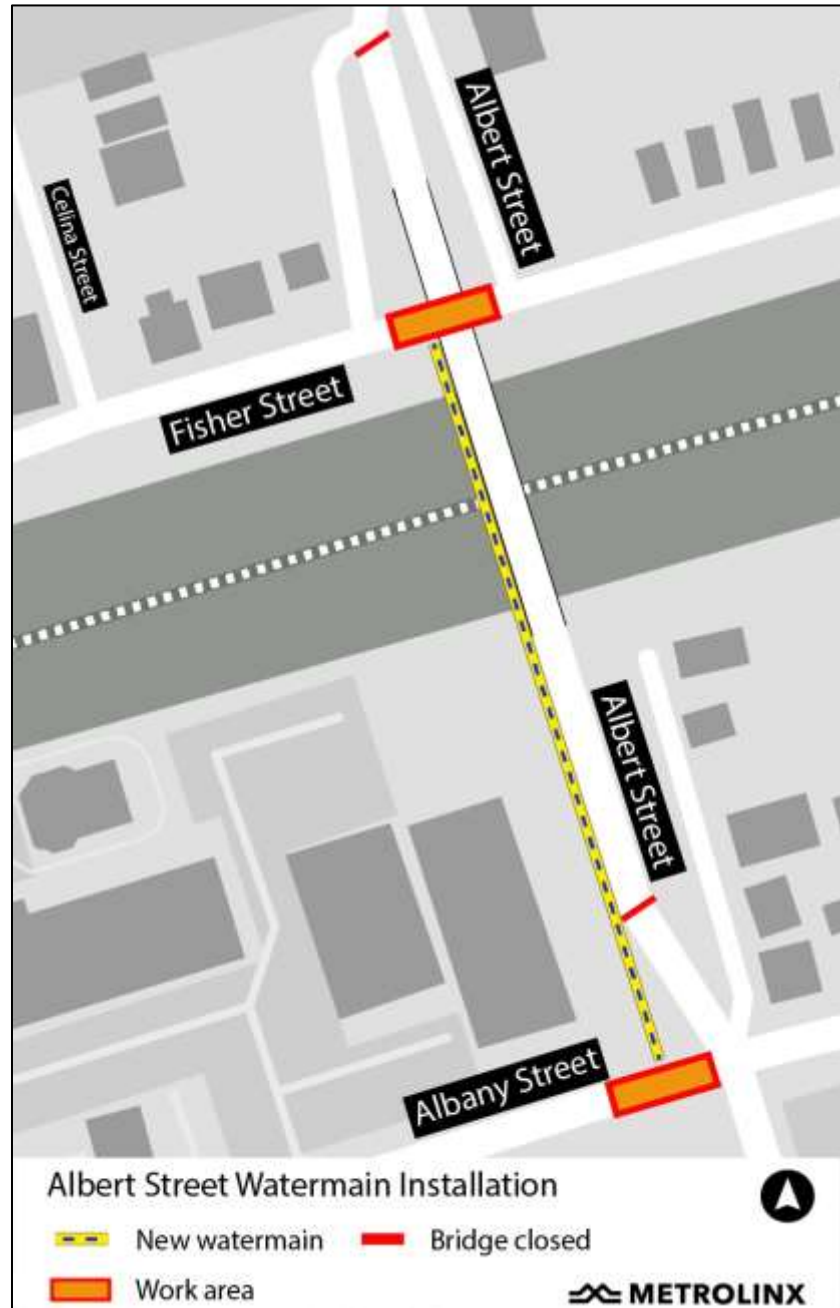

HOURS OF WORK

- Work will take place Monday to Friday, between 7:00 a.m. and 7:00 p.m., and will move within the work area highlighted on the map until July 2025.
- Daytime working hours are scheduled whenever possible. However, some activities are scheduled overnight when micro tunnelling is taking place.
- Work hours may be extended or rescheduled due to inclement weather, unforeseen circumstances or to advance work.

WHAT TO EXPECT

- Residents should expect some noise, vibration, and dust due to construction activities.
- Micro tunneling is a trenchless method that uses a guided boring system to install underground water mains.
- Site lighting will be used but pointed away from resident's homes.
- Staff will take reasonable precautions to minimize disturbances to residents and commuters, including but not limited to the following:
 - Reduced idling of non-essential equipment.
 - Safely securing the work area.
 - White noise backup alarms on vehicles and machinery as required.
 - Noise and vibration monitoring and mitigation measures as required.
 - Fencing and signage.
- Work will take place within the rail corridor and on public roadways and land.
- Removal of low-lying vegetation.

PEDESTRIAN DETAILS

- Pedestrians will be rerouted around work zones via delineated temporary detours, as shown in the map.
- Please continue to exercise caution around active construction sites.

TRAFFIC AND TRANSIT DETAILS

- Fisher Street traffic will be detoured on Albert Street around the bridge.
- Albany Street traffic will be detoured south on Albert Street to Elena Avenue.
- There are no additional impacts to transit anticipated.

OTHER INFORMATION

- Metrolinx has a dedicated community engagement team that works with residents and businesses in the area.
- If you have any questions, please contact us using the information provided below.
- We apologize for any inconvenience and ask for your patience as we complete this critical work.

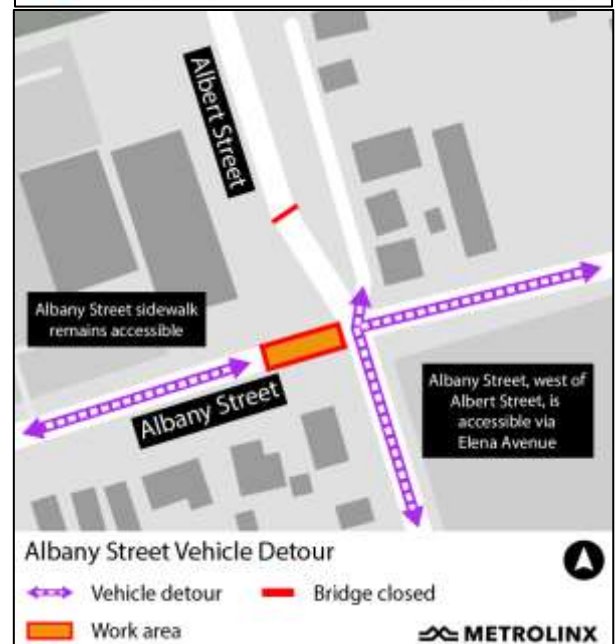
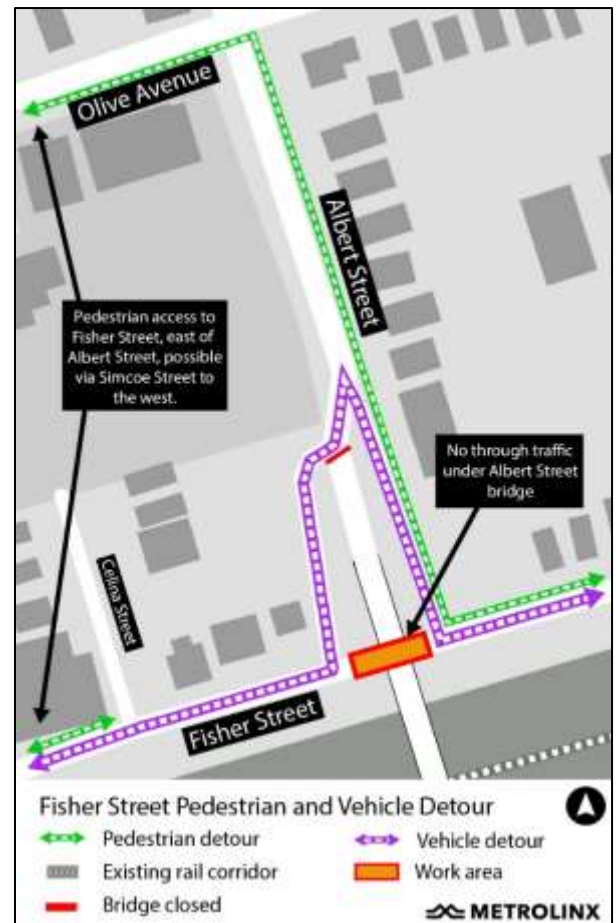

This notice can be translated into a different language upon request by emailing us at DurhamRegion@metrolinx.com

Cet avis de travaux de construction est disponible en français sur demande. Si vous êtes intéressé, veuillez envoyer un courriel à DurhamRegion@metrolinx.com

Contact Us:

✉ Write to us at: DurhamRegion@metrolinx.com

✂ Find us on X: [@GOExpansion](https://twitter.com/GOExpansion)

🌐 Visit the website: www.metrolinx.com/Bowmanville