

Update: Test pits on Don Mills Road

Expected start date: April 21, 2025

Expected duration: six (6) weeks

What is happening?

- Starting April 21, 2025, crews will conduct test pit investigations along Don Mills Road and intersecting roads in several locations. This work will enable future construction activities for the Ontario Line project and protect nearby buildings and infrastructure.
- Test pits are shallow, targeted excavations to confirm the location of buried utility connections. Construction crews will use a hydrovac truck and survey equipment to gather information to progress with the design development phase.
- This construction work will take place on weekdays from 8 a.m. to 5 p.m.

What to Expect?

- Traffic lanes will be temporarily impacted near test pit work areas. These work zones will have pylons and barricades to provide safe distances between pedestrians, cyclists and traffic.
- Crews will always maintain one lane of traffic per direction throughout the duration of work.
- Traffic signs will be erected in areas where turns are temporarily restricted.
- Some work zones may require short-term pedestrian sidewalks closures. In these circumstances, signage will direct pedestrians to alternative routes.
- Residents should expect some noise, vibration and dust. Work crews will take reasonable precautions to minimize disturbances to residents.
- Crews will excavate one test pit at a time, and the work zone will be safely delineated. The work area will be restored to existing conditions at the end of each workday.
- Construction work may be postponed or rescheduled due to unforeseen weather conditions or other construction-related impacts.

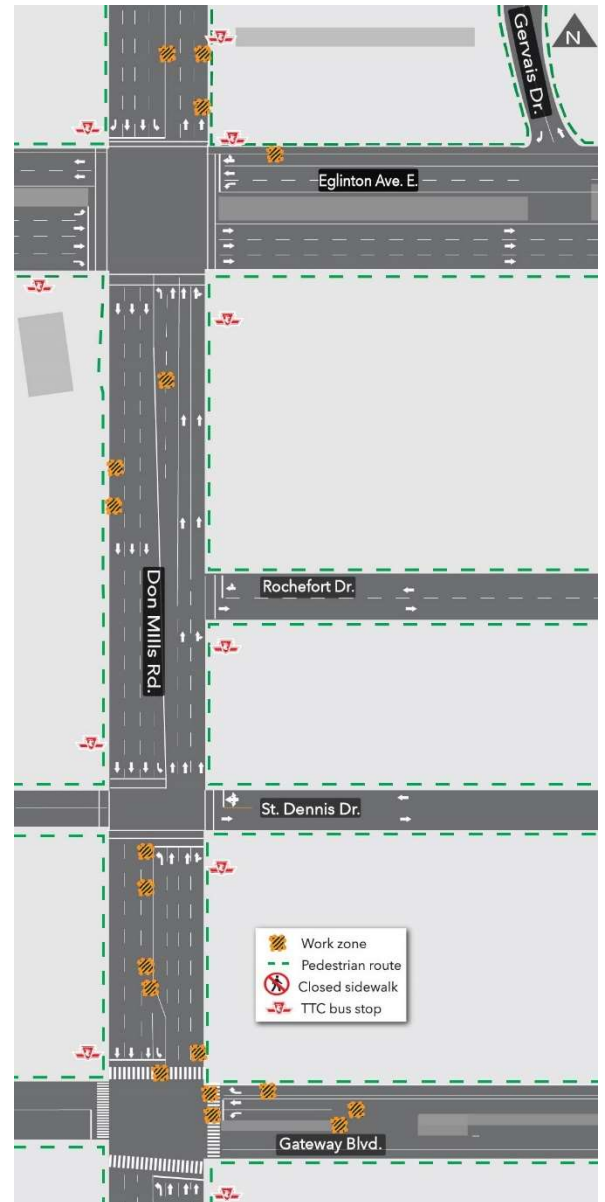

Contact us:

Call us 24/7 at: [416-202-5100](tel:416-202-5100)
 Write to us at: ontarioline@metrolinx.com
 Find us on Twitter, Facebook, and Instagram: [@ontarioline](https://www.instagram.com/ontarioline)
 Visit the website: www.metrolinx.com/ontarioline

Visit our community offices:

Riverside:
 770 Queen St. E, Toronto, ON, M4M 1H4

General hours:

- Mondays, Tuesdays and Fridays: 9 a.m. to 5 p.m.
- Wednesdays and Thursdays: 10 a.m. to 6 p.m.

Thornccliffe Park:

East York Town Centre
 45 Overlea Blvd., Toronto, ON M4H 1C3
 Unit 153 (across from the Rogers store)

General hours:

- Monday to Friday: 9 a.m. to 5 p.m.

Disponible en français sur demande. Si vous êtes intéressé, veuillez envoyer un courriel à ontarioline@metrolinx.com

**Note: Work may be delayed or rescheduled due to unforeseen circumstances.*