

# Overnight directional drilling for utility relocation at Beth Neilson Drive

**Expected Start Date:** Early June 2025

**Expected Duration:** Four (4) months

**Hours of work:** Weekdays from 7 p.m. to 7 a.m.

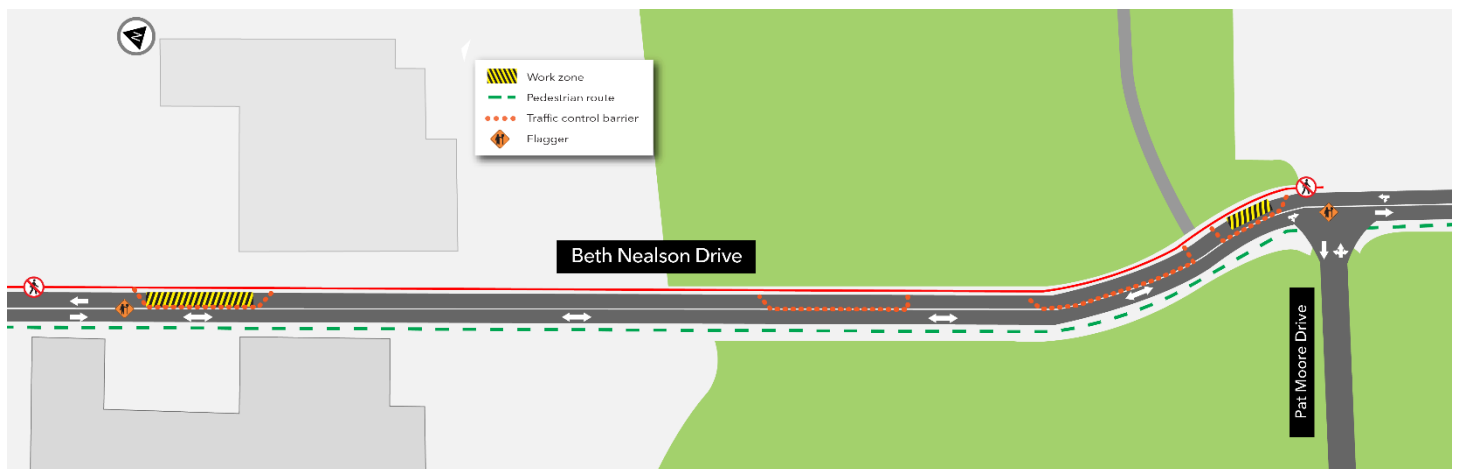

## What is Happening?

- Metrolinx will construct an underpass on Beth Neilson Drive for Ontario Line trains to run-at grade while lowering the road for existing traffic
- Before construction begins for the underpass, utility companies will carry out utility relocations.
- As part of these utility relocations, Bell Canada will use a directional drill to install new infrastructure to enable cable relocations.
- Directional drilling work is forecast to begin in June 2 2025 and is projected to be completed in four months.
- Once directional drilling is complete, Bell will conduct cable pulling/splicing, as well as cutover works.
- Additional notice will be shared with the community ahead of the transition to cable pulling work.

# What to expect

## Construction

- Crews will construct a launch pit on Thorncliffe Park Drive near Pat Moore Drive, as well as a receiving pit further north on Beth Neilson Drive.
- From the launch pit crews will use a directional drilling machine to install new infrastructure towards Wicksteed Avenue.

## Traffic and Pedestrian Details

- There will be a single lane closure on Beth Neilson Drive.
- Bi-directional traffic will be maintained throughout work.
- Bi-directional traffic will be maintained by traffic control personnel at either end of the single lane closure.
- The east sidewalk on Beth Neilson will be closed, and pedestrians will be detoured to the nearest crossing points using posted signage.

## Safety

- Signage will be posted around the site to direct pedestrians.
- Equipment may be left on site but will be properly secured and stored to ensure safety.

## About the Ontario Line

- 15.6-kilometre subway line that will make it faster and easier to travel within Toronto and beyond.
- 15 stops and more than 40 connections to other transit, including GO train, subway, LRT, streetcar, and bus lines.
- Less than 30 minutes from one end of the line to the other.
- 28,000 fewer cars on the road each day.

### Contact us:

Call us 24/7 at: **416-202-5100**

Write to us at:

**[ontarioline@metrolinx.com](mailto:ontarioline@metrolinx.com)**

Find us on Twitter, Facebook, and

Instagram: **[@ontarioline](#)**

Visit our website:

**[www.metrolinx.com/ontarioline](http://www.metrolinx.com/ontarioline)**

### Visit our community offices:

**770 Queen Street East (near Queen & Broadview)**

General hours:

Mondays, Tuesdays, and Fridays: 9 a.m. to 5 p.m.

Wednesdays and Thursdays: 10 a.m. to 6 p.m.

### Thorncliffe Park:

East York Town Centre

45 Overlea Blvd., Toronto, ON M4H 1C3

Unit 153 (across from the Rogers store)

General hours:

Monday to Friday, 9 a.m. to 5 p.m.