

# Geotechnical Instrumentation and Monitoring Program on Pape Avenue and Surrounding Streets

**Expected start date:** As early as July 25, 2025

**Program duration:** Ongoing throughout construction

**Hours of Work:** Monday to Friday, 7 a.m. to 7 p.m.

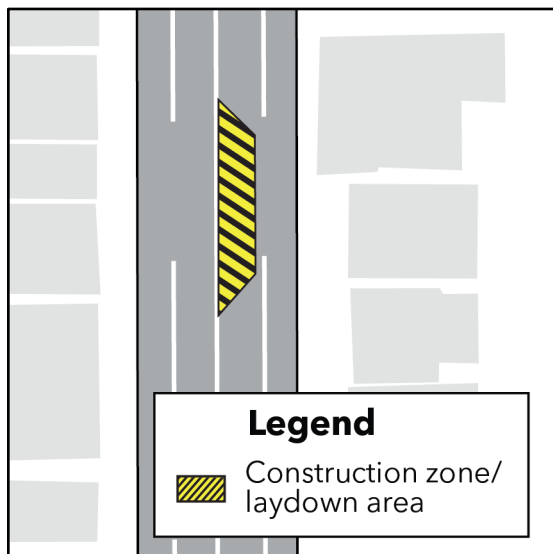

Typical four-lane road occupancy for equipment installation

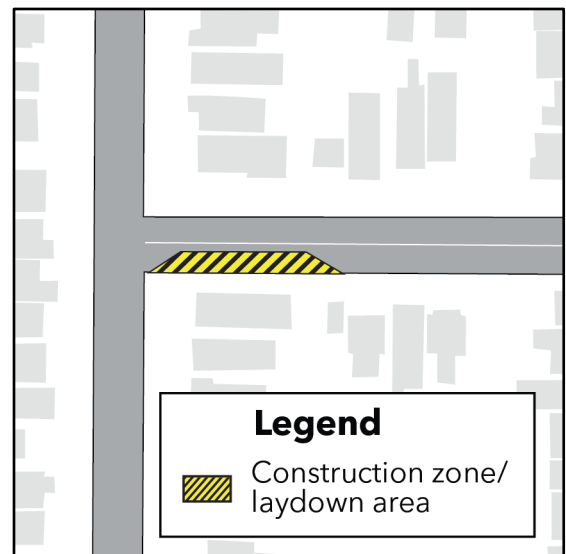

Typical two-lane, or one-way road occupancy for equipment installation

## What is happening?

- To enable future Ontario Line construction activities, a geotechnical instrumentation monitoring program will begin along Pape Avenue and surrounding streets.
- The program involves placing structural monitoring tools (instruments) within and close to our work sites and the future tunnels to help monitor and protect nearby structures.
- The program begins with installation of monitoring tools starting in late July 2025 to align with the start of support of excavation works at sites along Pape Avenue. Monitoring will be ongoing throughout construction.

## What to expect

- Each work zone will be temporarily blocked off for safety until installation is complete.
- The installation is done in five stages which are typically performed on the same day:
  - Crews begin by spray-painting to mark the locations of utilities.
  - Once the location is confirmed and the work area is closed, crews will drill a small hole through the concrete or asphalt.
  - A hydrovac truck will be used to vacuum soil from the hole to a depth of about 1.5 metres.
  - After clearing the hole, crews will install the monitoring tool\*. Monitoring tools sit flush with the ground. Gaps will be backfilled and sealed with grout.
  - Some monitoring tools automatically transmit data remotely, while others require periodic readings by a survey team on-site.
  - \* Some monitoring tools require a deeper installation and the use of a drill rig. These monitors are installed up to 40 metres deep.
- Work involves the use of a coring machine, hydrovac truck and a track-mounted drill rig.
- During some phases of work, noise and dust from construction equipment is expected.
- Depending on the required tools (instrumentation), installation takes between one hour to three days.
- There will be temporary impacts to pedestrian access, traffic lanes and on-street parking.
- Efforts will be made to not leave equipment on-site outside of work hours.
- Work may be delayed or rescheduled due to inclement weather or unforeseen circumstances.



Figure 1: *Examples of monitoring instruments during installation. After installation, instrument covers lay flush with the ground and the pylons are removed.*

## What's Next

- Once installed, the monitoring tools will record vital geotechnical and utility information to help protect nearby structures.
- As construction for the Ontario Line progresses and required geotechnical instrumentation tools are installed, the monitoring program will be implemented and maintained for the project lifecycle.

We will continue to assess impacts and provide neighbourhood notices in advance of any work to keep you up to date and informed. For more information about upcoming work, please see [metrolinx.com/ontarioline](http://metrolinx.com/ontarioline) or sign up for the e-newsletter.

## About the Project

- 15.6-kilometre subway line that will make it faster and easier to travel within Toronto and beyond.
- 15 stops and more than 40 connections to other transit, including GO train, subway, LRT, streetcar, and bus lines.
- Less than 30 minutes from one end of the line to the other.
- 28,000 fewer cars on the road each day.

### Contact us:

Call us 24/7 at: [416-202-5100](tel:416-202-5100)

Write to us at: [ontarioline@metrolinx.com](mailto:ontarioline@metrolinx.com)

Find us on Twitter, Facebook, and Instagram: [@ontarioline](https://twitter.com/ontarioline)

Visit the website: [www.metrolinx.com/ontarioline](http://www.metrolinx.com/ontarioline)

### Visit our community offices:

#### Riverside:

770 Queen St. E, Toronto, ON, M4M 1H4

General hours:

- Mondays, Tuesdays and Fridays: 9 a.m. to 5 p.m.
- Wednesdays and Thursdays: 10 a.m. to 6 p.m.

#### Thorncliffe Park:

East York Town Centre

45 Overlea Blvd., Toronto, ON M4H 1C3

Unit 153 (across from the Rogers store)

General hours:

- Monday to Friday: 9 a.m. to 5 p.m.

Disponible en français sur demande. Si vous êtes intéressé, veuillez envoyer un courriel à [ontarioline@metrolinx.com](mailto:ontarioline@metrolinx.com).

本通知提供简体中文版。如需获取, 请发送电邮至 [ontarioline@metrolinx.com](mailto:ontarioline@metrolinx.com)。

本告示有繁體中文版本。請發送電郵至 [ontarioline@metrolinx.com](mailto:ontarioline@metrolinx.com) 索取副本。

Η παρούσα ανακοίνωση είναι διαθέσιμη στα ελληνικά. Αποστείλετε email στο [ontarioline@metrolinx.com](mailto:ontarioline@metrolinx.com) για να ζητήσετε αντίγραφο.