

Update: Geotechnical work on Pape Avenue and Fulton Avenue

Expected start date: As early as July 28, 2025

Expected duration: One night

Hours of work: Overnight, 9 p.m. – 5 a.m.

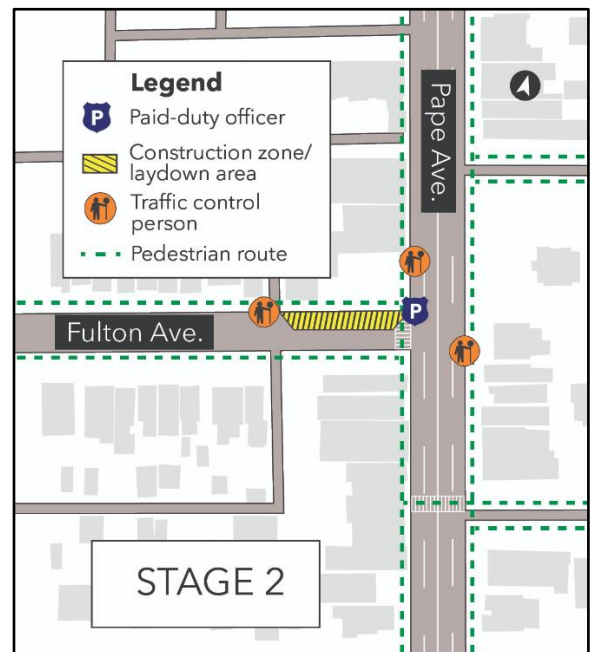
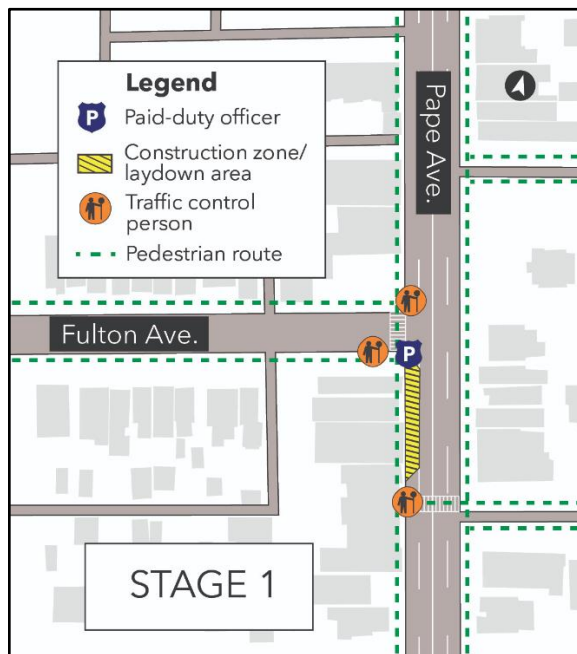

What is happening?

- To enable future construction activities for the Ontario Line project, crews will be conducting geotechnical investigations at the intersection of Pape Avenue and Fulton Avenue.
- Geotechnical investigations consist of drilling boreholes. These investigations are essential to understand soil and rock properties, minimize construction risk and protect nearby buildings and infrastructure.

What to expect

- Work will take place overnight, from 9 p.m. to 5 a.m.
- Drilling and excavation equipment, such as drill rigs and water hauling, hydrovac, concrete and coring trucks will be on site. During the vertical drilling phase, noise, dust and vibration from construction equipment is expected.

- The work will occur in two stages:
 - **Stage 1:** Beginning at 9 p.m. on the night of July 28, 2025, the southbound curbside lane of Pape Avenue at the intersection of Pape Avenue and Fulton Avenue will be closed.
 - **Stage 2:** Beginning around 1:00 a.m. July 29, 2025, the southbound curbside lane of Pape Avenue will re-open. Fulton Avenue will be reduced to one lane in the vicinity of the work zone, but bi-directional traffic will be maintained by traffic control personnel.
- Access to the south side of Fulton Avenue, as well as residential and commercial driveways will be maintained.
- Signage and safety barriers will be in place to delineate work zones.
- Paid-duty officers and traffic control personnel will be on-site managing traffic and pedestrian flow. The site will be supervised throughout the work.
- Mobile lights may be used to illuminate the site and ensure safe working conditions.
- TTC bus service will be maintained throughout the work.
- Timing of construction is subject to weather conditions and construction constraints.
- Dust will be mitigated by misting and sweeping.

We will continue to assess impacts and provide neighbourhood notices in advance of any work to keep you up to date and informed. For more information about upcoming work, please see metrolinx.com/ontarioline or sign up for the e-newsletter.

About the project

- 15.6-kilometre subway line that will make it faster and easier to travel within Toronto and beyond.
- 15 stops and more than 40 connections to other transit, including GO train, subway, LRT, streetcar and bus lines.
- Less than 30 minutes from one end of the line to the other.
- 28,000 fewer cars on the road each day.

Contact us:

Call us 24/7 at: [416-202-5100](tel:416-202-5100)

Write to us at: ontarioline@metrolinx.com

Find us on Twitter, Facebook, and Instagram: [@ontarioline](https://www.instagram.com/ontarioline)

Visit the website: www.metrolinx.com/ontarioline

Visit our community offices:

Riverside:

770 Queen St. E, Toronto, ON, M4M 1H4

General hours:

- Mondays, Tuesdays and Fridays: 9 a.m. to 5 p.m.
- Wednesdays and Thursdays: 10 a.m. to 6 p.m.

Thorncliffe Park:

East York Town Centre

45 Overlea Blvd., Toronto, ON M4H 1C3

Unit 153 (across from the Rogers store)

General hours:

- Monday to Friday: 9 a.m. to 5 p.m.

Disponible en français sur demande. Si vous êtes intéressé, veuillez envoyer un courriel à ontarioline@metrolinx.com.