

Subsurface utilities investigation on Pape Avenue south of Langley Avenue

Expected start date: As early as July 23, 2025

Expected duration: One day

Hours of work: Monday to Friday: 9 a.m. – 3 p.m.

What is happening?

- To enable future construction activities for the Ontario Line, crews will be conducting subsurface utilities investigations along Pape Avenue, south of Langley Avenue.
- Investigations consist of small test hole drilling on the road. Utilities investigations are essential to understanding the location and position of utilities that exist near the future Ontario Line tunnel alignment.

What to expect

- The east side lane (odd number side) of Pape Avenue will be closed for utility investigations.
- Access to Lane South Riverdale East Pape will be maintained. Traffic control personnel will assist drivers.
- Driveways may experience temporary disruptions, but access will be maintained.
- Traffic control personnel will be in place to assist residents with driveway access.
- A hydrovac may be on site, depending on the investigation work required.
- Signage will be in place to delineate work zones.
- During some phases of work, noise and dust from construction equipment is expected.

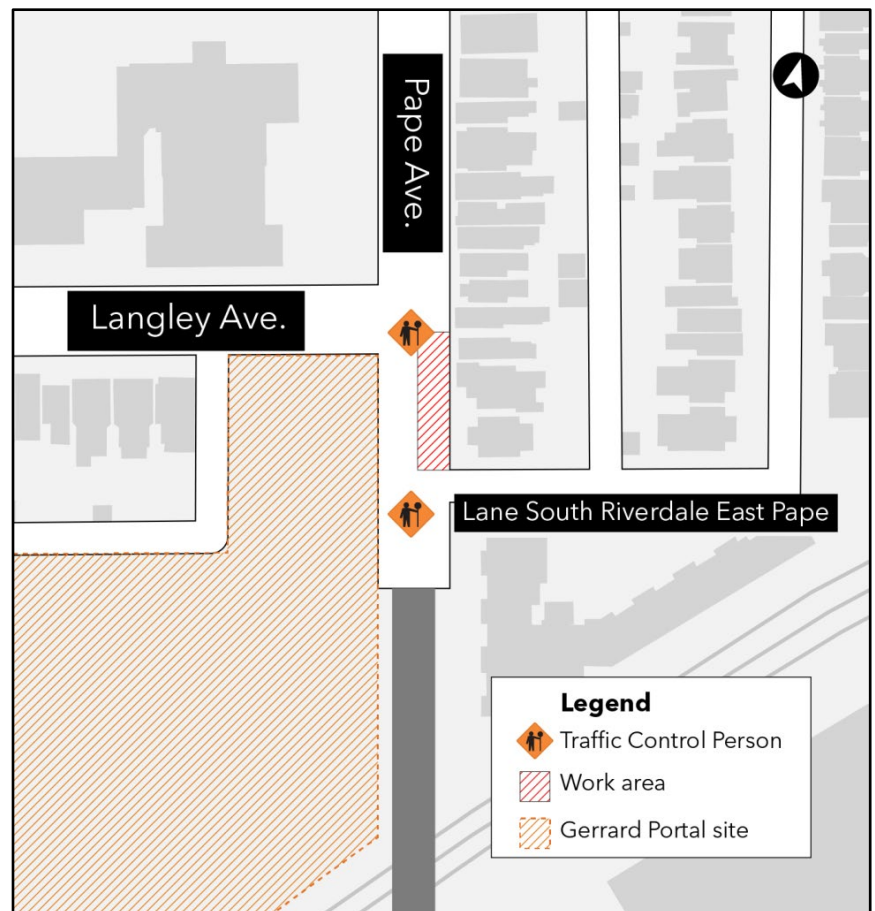

- Safety barriers will be placed around the maintenance hole or road cut area. The site will be supervised throughout the work.
- Traffic control personnel will be on-site managing traffic flow, if required.
- Underground utilities will be marked using temporary spray paint and chalk.
- Timing of construction is subject to weather conditions and construction constraints.

We will continue to assess impacts and provide neighbourhood notices in advance of any work to keep you up to date and informed. For more information about upcoming work, please see metrolinx.com/ontarioline or sign up for the e-newsletter.

About the project

- 15.6-kilometre subway line that will make it faster and easier to travel within Toronto and beyond.
- 15 stops and more than 40 connections to other transit, including GO train, subway, LRT, streetcar and bus lines.
- Less than 30 minutes from one end of the line to the other.
- 28,000 fewer cars on the road each day.

Contact us:

Call us 24/7 at: [416-202-5100](tel:416-202-5100)

Write to us at: ontarioline@metrolinx.com

Find us on Twitter, Facebook, and Instagram: [@ontarioline](https://www.instagram.com/ontarioline)

Visit the website: www.metrolinx.com/ontarioline

Visit our community offices:

Riverside:

770 Queen St. E, Toronto, ON, M4M 1H4

General hours:

- Mondays, Tuesdays and Fridays: 9 a.m. to 5 p.m.
- Wednesdays and Thursdays: 10 a.m. to 6 p.m.

Thorncliffe Park:

East York Town Centre

45 Overlea Blvd., Toronto, ON M4H 1C3

Unit 153 (across from the Rogers store)

General hours:

- Monday to Friday: 9 a.m. to 5 p.m.

Disponible en français sur demande. Si vous êtes intéressé, veuillez envoyer un courriel à ontarioline@metrolinx.com.

本通知提供简体中文版。如需获取, 请发送电邮至 ontarioline@metrolinx.com。

本告示有繁體中文版本。請發送電郵至 ontarioline@metrolinx.com 索取副本。