

Update: Access road relocation at De Grassi Street and Strange Street

Expected timelines:

- **Degrassi Street:** As early as Tuesday, September 2, 2025
- **Strange Street:** In late September 2025
- **Duration:** It will take approximately one week to relocate each access road

Hours of work: Monday - Friday, between 7 a.m. - 5 p.m.

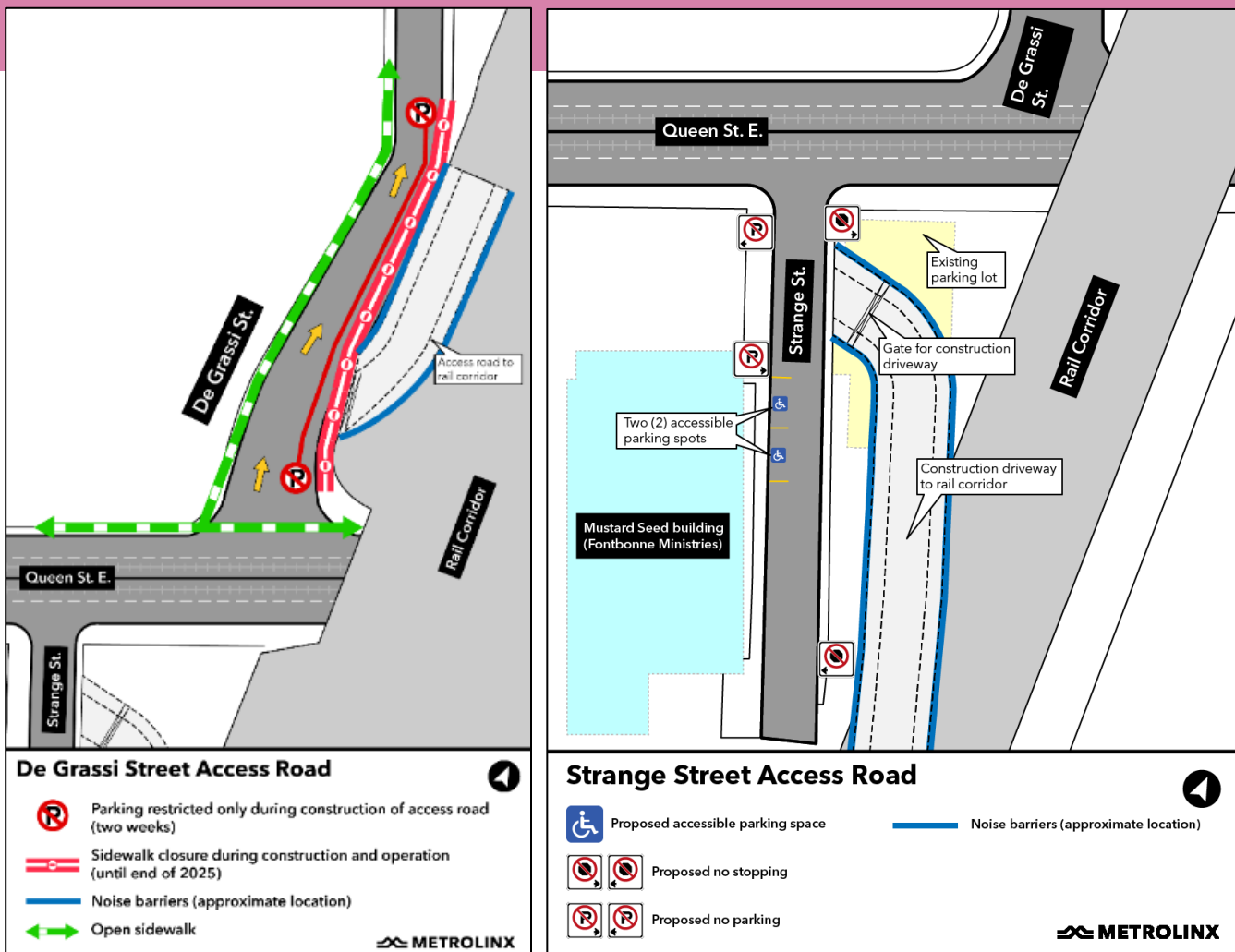

What is happening?

- Access roads at Degrassi Street and Strange Street will be relocated closer to Queen Street East to enable retaining wall construction.
- New locations are shown on the maps above.
- The access road at Degrassi Street will be relocated as early as Tuesday, September 2, 2025.

- The access road at Strange Street will be relocated in late September 2025.
- The area where the access roads are currently located will be closed off and secured with hoarding or fencing.
- These access roads will remain in operation until the end of the year.
- Access roads will be secured with fencing and filter screens, and mud mats will be installed to minimize dust.
- Solid noise barriers will be installed around the access road to mitigate construction impacts including noise and dust. The barriers will be approximately three metres tall.
- Access road construction will take place during the daytime from Monday to Friday between 7 a.m. and 5 p.m. **Crews will do their best to avoid weekend work. Advance notice will be provided if weekend work is required.**
- Construction activities will include excavation, concrete breaking, compaction, grading, paving and clearing of vegetation and trees.
- These access roads are required to bring construction equipment and materials in and out of the rail corridor safely – the roads enable construction of new retaining walls and noise barriers on the west side of the corridor.
- Temporary traffic and pedestrian diversions will be required to build the access roads.

What to expect

- Noise and vibration from construction equipment including loaders, excavators, trucks, vibratory rollers, hand tampers and other machinery.
- Compaction work will be required to ensure the access road is stable and can support the weight of construction vehicles. Residents in nearby properties may feel vibrations during this compaction work. Vibration monitoring is in place to ensure levels stay within regulatory limits.
- The existing retaining wall and fencing between the rail corridor and sidewalk will be removed.
- Construction fencing, safety barriers and warning signage will be posted around each access road.
- Residents and businesses will notice construction crews, equipment, installation of safety hoarding and material deliveries near the construction areas shown on the image above.
- Work may be delayed due to weather conditions or unforeseen circumstances.

About the project

- 15.6-kilometre subway line that will make it faster and easier to travel within Toronto and beyond.
- 15 stops and more than 40 transit connections, including GO, TTC, and more.
- Approximately 30 minutes from one end of the line to the other.
- 28,000 fewer cars on the road each day.

Contact us:

Call us 24/7 at: [416-202-5100](tel:416-202-5100)

Write to us at:

ontarioline@metrolinx.com Find us

on X, Facebook, and Instagram:

[@ontarioline](https://www.ontarioline.com)

Visit the website:

www.metrolinx.com/ontarioline

Visit our community offices:

770 Queen Street East (near Queen & Broadview)

General hours:

Mondays, Tuesdays, and Fridays:

9:00 a.m. to 5:00 p.m.

Wednesday: 1:00 p.m. to 6:00 p.m.

Thursday: 10:00 a.m. to 6:00 p.m.

Pape/Danforth:

810 Danforth Ave

Between Woodcrest & Langford

General Hours:

Monday – Friday:

9:00 a.m. – 5:00 p.m.

Thorncliffe Park:

East York Town Centre

45 Overlea Blvd., Toronto, ON M4H 1C3 Unit 153

(across from the Rogers store) General hours:

Monday – Friday, 9 a.m. – 5 p.m.