

Piling installation at Martin Grove Road and Eglinton Avenue West

Scheduled start: October 2025

Expected completion: Summer 2026

Construction hours: Weekdays - 7:00 a.m. to 7:00 p.m.

Map of work area:

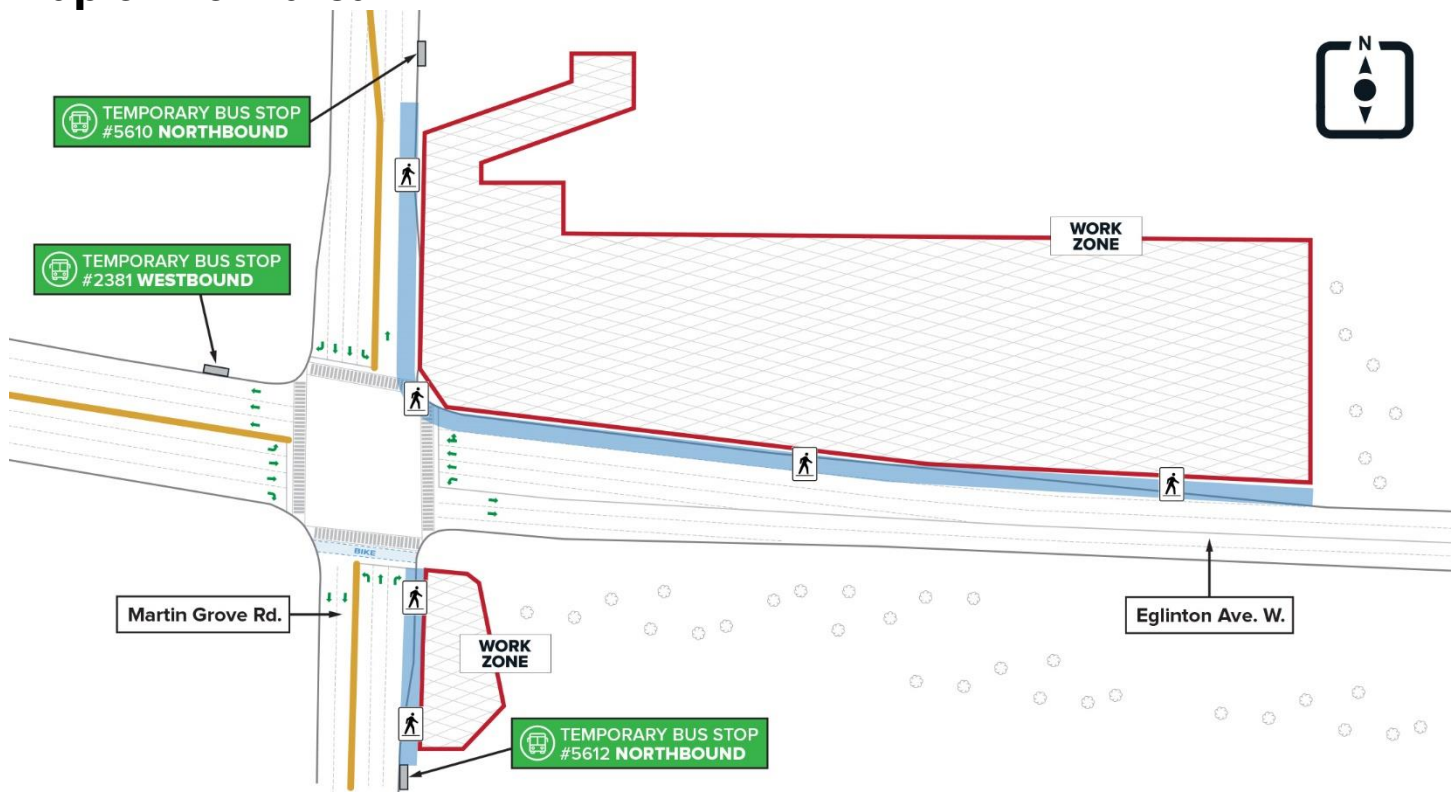

What is happening?

- Crews working on behalf of Metrolinx will be starting piling work for station box construction at Martin Grove Road and Eglinton Avenue West.
- A station box is an underground box-like structure that forms the main body of a transit station.
- Piling installation is when crews drill columns of reinforced concrete into the ground to create the foundation and framework for the future underground station.

What to expect

- Residents can expect to see and hear noise from large machinery, such as drill rigs, excavators, dump trucks and equipment. Construction lighting may be visible on the work site.
- Measures are being put in place to reduce dust, including the use of water sprayers and biodegradable dust suppressants.
- Noise barrier walls will be installed to dampen and reduce noise from construction.
- Weekend or overnight work may be required. Residents will be provided with updates as they are made available.
- The information provided is anticipated based on the current construction schedule and is subject to change.
- The construction team is currently pursuing permits from the City of Toronto and will begin work once permits are issued.

Traffic and pedestrian impacts

- One northbound lane will be closed on both sides of the intersection on Eglinton Avenue West.
- Northbound bus stop #5612 on the southeast corner of the intersection will be temporarily relocated 100m farther south.
- Northbound bus stop #5610 on the northeast corner of the intersection will be temporarily relocated 100m north.
- Westbound bus stop #2381 on the northeast corner of the intersection will be temporarily relocated to the northwest corner of the intersection.
- The sidewalk on the southeast corner of the intersection will be temporarily detoured to accommodate construction.
- Traffic and pedestrian impacts will occur in future stages. Further notification will be provided.

About the project

- The Eglinton Crosstown West Extension will bring even more rapid transit to Etobicoke and Mississauga, making it easier for people to get where they need to be each day.
- The extension of Line 5 Eglinton will run 9.2 kilometres from the Mount Dennis station to Renforth Drive and will operate mainly underground. Once complete, it will create a continuous rapid transit line that stretches from Scarborough, through midtown Toronto, and into Mississauga.

Contact Us:

✉ Write to us at: EglintonWest@metrolinx.com

🐦 Find us on Twitter [@EglintonWestEXT](https://twitter.com/EglintonWestEXT)

☎ Call us at 416-202-8001

🌐 Visit the website: www.metrolinx.com/EglintonWest

Disponible en français sur demande. Si vous êtes intéressé, veuillez envoyer un courriel à EglintonWest@metrolinx.com.