

Bain Emergency Exit Building - Support of Excavation Construction

Expected start date: Mobilization starting as early as September 29, 2025, support of excavation starting as early as late-October 2025

Expected duration: 19 months

Hours of Work: Monday to Friday, 7 a.m. to 7 p.m. and Saturday 7 a.m. to 7 p.m.

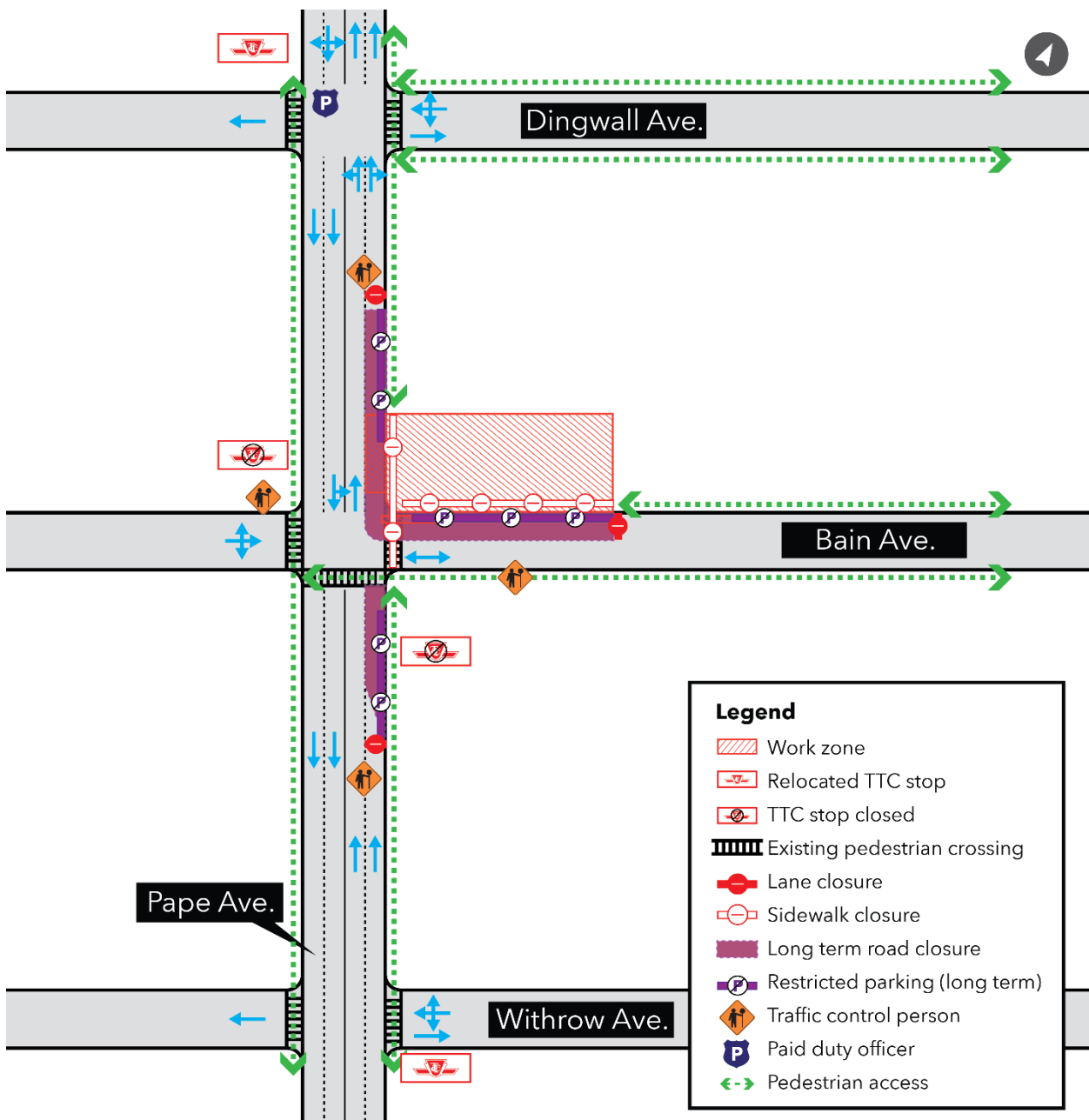

What is Happening?

- The northeast corner of Pape Avenue and Bain Avenue is the future site of an emergency exit building (EEB) for the Ontario Line. These buildings are spaced between stations to provide exits for riders and access for first responders in the event of an emergency.
- The next phase of work will involve preparing the Bain emergency exit building site for excavation.

Work Completed to Date

- Structural demolitions of the Metrolinx-owned properties at 495 and 497 Pape Avenue.
- Removal of vegetation and trees from the site and surrounding areas.
- Geotechnical investigations conducted at the site and along the Pape Avenue corridor.

What to Expect

- Mobilization by site crews to bring equipment that supports construction activities will begin on September 29.
- Preparation for site activities including the installation of a power generator and noise barriers should take place until late October.
- For approximately 8 months, a ground improvement process called jet grouting will be conducted at the site.
 - Jet grouting is a soil stabilization technique that involves injecting grout deep into the soil.
 - The grout replaces the existing soil and hardens, adding stability near where excavation work will occur.
- Once jet grouting is completed, crews will begin drilling piles to support excavation activities for approximately 11 months.
 - Drilling piles involves using large drills to create vertical holes in the ground.
 - Steel reinforcement cages are inserted into the drilled holes to provide additional strength and stability.
 - Finally, concrete is poured into the holes, securing the piles in place. Temporary casings are used during drilling.
- All equipment on-site will have regular inspections to ensure they are operating effectively.
- Noise, air quality, and vibration monitors will be in place. These devices will help to detect excessive noise and dust early to proactively conduct corrective actions as needed while crews drill piles.
- Signage and safety barriers will be in place to delineate work zones.

Traffic and Pedestrian Impacts

- The pedestrian north-south crosswalk on the east side of Pape Avenue and Bain Avenue will be closed.
- During this phase of construction, approximately 11 permit parking spots on Bain Avenue and Pape Avenue will be restricted to accommodate a long-term road closure.
- Motor vehicles traveling north on Pape Avenue will be restricted to one lane between Withrow Avenue and Dingwall Avenue.
- TTC bus stops for Bain Avenue will be relocated near Dingwall Avenue for transit commuters traveling south and Withrow Avenue for transit commuters traveling north.
- Approximately 10 dump trucks and 8 tractor trailers will be on-site daily to support construction activities.
- To enter the site, construction vehicles will travel south down Bayview Avenue, east along Gerrard Street, then north along Carlaw Avenue and Riverdale Avenue up to Bain Avenue.
- To exit the site, construction vehicles will travel north on Pape Avenue, then east along O'Connor Drive before entering the Don Valley Parkway on Don Mills Road.

What's Next?

The design rendering for the future Bain EEB is subject to change. For more information about upcoming work, please see metrolinx.com/ontarioline or sign up for the e-newsletter.



About the Project

- 15.6-kilometre subway line that will make it faster and easier to travel within Toronto and beyond.
- 15 stops and more than 40 connections to other transit, including GO train, subway, LRT, streetcar and bus lines.
- Less than 30 minutes from one end of the line to the other.
- 28,000 fewer cars on the road each day.

Contact us:

Call us 24/7 at: [416-202-5100](tel:416-202-5100)

Write to us at: ontarioline@metrolinx.com

Find us on Twitter, Facebook, and Instagram: [@ontarioline](#)

Visit the website: www.metrolinx.com/ontarioline

Visit our Pape Avenue community office:

810 Danforth Ave, Toronto, ON M4J 1L6

General hours:

- Mondays, Tuesdays and Fridays: 9 a.m. to 5 p.m.

Or visit our other community offices:

- Leslieville: 770 Queen St. E, Toronto, ON M4M 1H4
- Thorncliffe Park: 45 Overlea Blvd (in the East York Town Centre), Unit 153, Toronto, ON M4H 1C3.

Disponible en français sur demande. Si vous êtes intéressé, veuillez envoyer un courriel à ontarioline@metrolinx.com.