

# Road and Sidewalk Restoration – Gowan Avenue and Pape Avenue

**Expected Start Date:** As early as October 6, 2025  
**Expected Duration:** Five (5) weeks  
**Hours of Work:** Monday to Friday, 7 a.m. to 7 p.m. and Saturday 9 a.m. to 7 p.m.

## What is happening?

- Earlier this year, crews undertook sewer relocation work in the vicinity of Gowan Avenue and Pape Avenue to move the existing sewer out of the way of future Cosburn Station construction. Following the sewer work, Toronto Hydro contractors moved into the area to perform electrical utility relocations. Now, crews are returning to fully restore the roads and sidewalks.
- Restoration will take place over five weeks, requiring three separate stages.

## What to expect

### Traffic and Pedestrian Impacts — Stage 1:

- A work zone will be established in the centre of Pape occupying the middle two lanes in the vicinity of the Pape-Gowan intersection, as well as the north or and south sidewalks.
- **Stage 1A** will occupy the south sidewalk on Gowan Avenue between Pape Avenue and the laneway west of Pape Avenue.
- **Stage 1B** will occupy the north sidewalk on Gowan Avenue between Pape Avenue and the laneway west of Pape Avenue.
- Traffic approaching Pape Avenue westbound and eastbound from Gowan Avenue must make a right turn. Through traffic and left turns will be restricted.
- Traffic will divert to the curb lanes around the work zone. One lane of traffic in each direction will be maintained.
- Curbside parking on Pape Avenue near the work zone will be restricted.
- There are no impacts to TTC bus service during this stage.
- This stage will take approximately two weeks to complete.

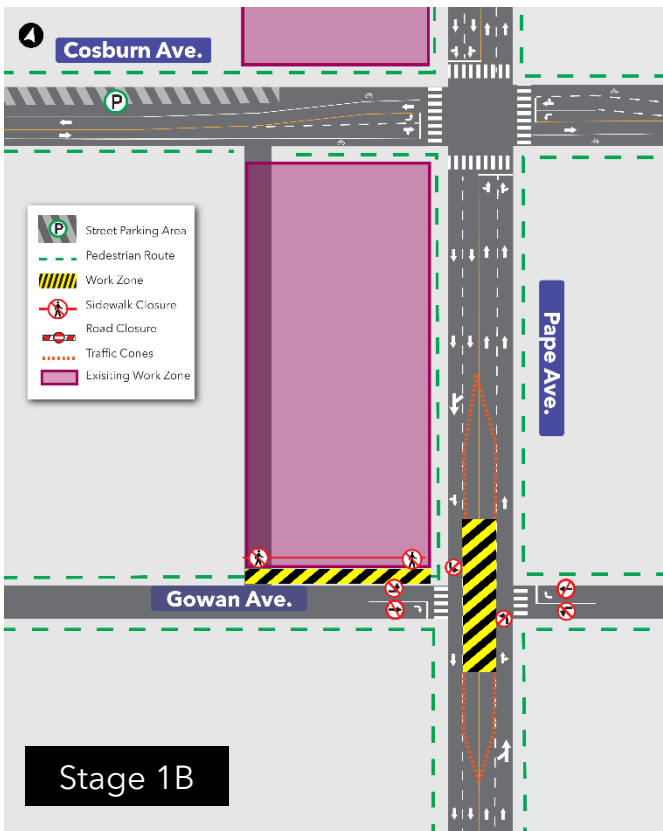
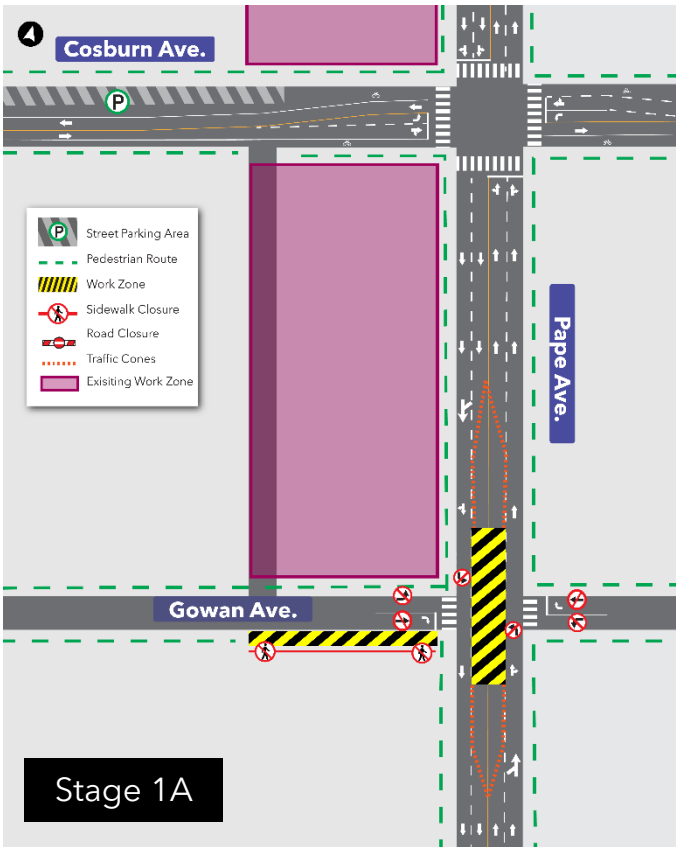

**Traffic and Pedestrian Impacts — Stage 2:**

- A work zone will be established on the west side of Pape Avenue extending into the Gowan-Pape intersection and west on Gowan Avenue to the laneway.
- Gowan Avenue will be fully closed west of Pape Avenue to the laneway.
- The westernmost two lanes on Pape Avenue will be occupied for the work zone. Traffic will divert to the eastern two lanes. One lane in each direction will be maintained.
- Curbside parking on Pape Avenue near the work zone will be restricted.
- Westbound traffic on Gowan Avenue approaching Pape Avenue must make a right turn. Through traffic and left turns will be restricted.
- The north-south crosswalk will be closed on the west side of Gowan and Pape. The north sidewalk on Gowan will remain open.
- There are no impacts to TTC bus service during this stage.
- This stage will take approximately three weeks to complete.

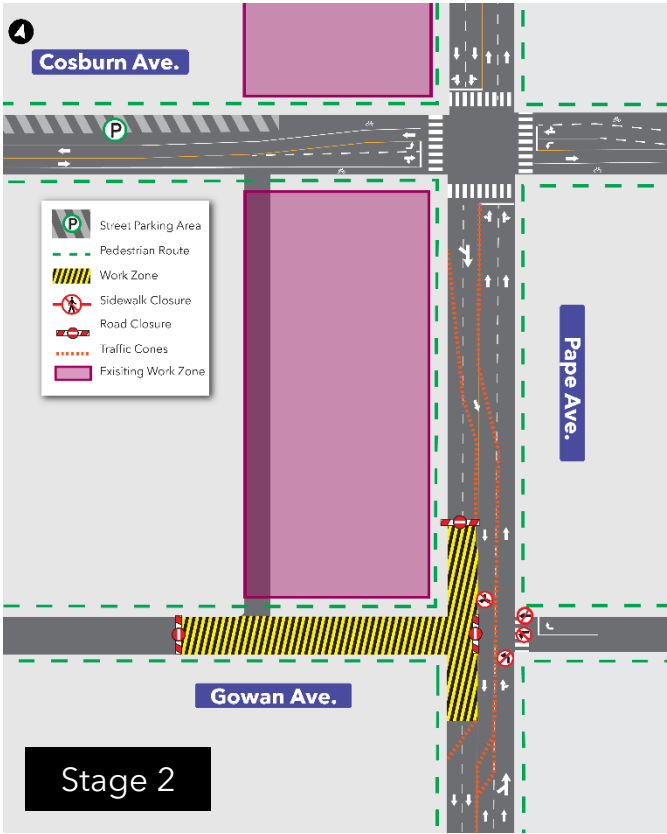

**Construction Notes**

- Work will involve jackhammering to remove temporary roadway followed by excavation, backfilling, compaction, and the pouring of concrete and asphalt to finalize the roads and sidewalks.
- Short-term traffic interruptions can be expected while trucks and other equipment enter and exit work zones. Traffic control personnel will be present to direct vehicles and pedestrians.
- Signage and safety barriers will be in place to outline work zones.
- Equipment will include a jackhammer, excavator, dump trucks, and concrete trucks.
- Work may be delayed due to inclement weather and/or unforeseen circumstances.

**About the Project**

- 15.6-kilometre subway line that will make it faster and easier to travel within Toronto and beyond.
- 15 stops and more than 40 connections to other transit, including GO train, subway, LRT, streetcar, and bus lines.
- Less than 30 minutes from one end of the line to the other.
- 28,000 fewer cars on the road each day.

**Contact us:**

Call us 24/7 at: [416-202-5100](tel:416-202-5100)  
Write to us at: [ontarioline@metrolinx.com](mailto:ontarioline@metrolinx.com)  
Find us on Twitter, Facebook, and Instagram: [@ontarioline](#)  
Visit the website: [www.metrolinx.com/ontarioline](http://www.metrolinx.com/ontarioline)

**Visit our Pape Avenue community office:**

810 Danforth Ave, Toronto, ON M4J 1L6  
General hours:  
• Mondays, Tuesdays and Fridays: 9 a.m. to 5 p.m.

**Or visit our other community offices:**

- Leslieville: 770 Queen St. E, Toronto, ON M4M 1H4
- Thorncliffe Park: 45 Overlea Blvd (in the East York Town Centre), Unit 153, Toronto, ON M4H 1C3.