

Borehole drilling on Eglinton Avenue near Eden Valley Drive

Expected start: May 4, 2026

Expected completion: May 25, 2026

Work hours: Daytime between 7:00 a.m. to 7:00 p.m.

Map of work area:

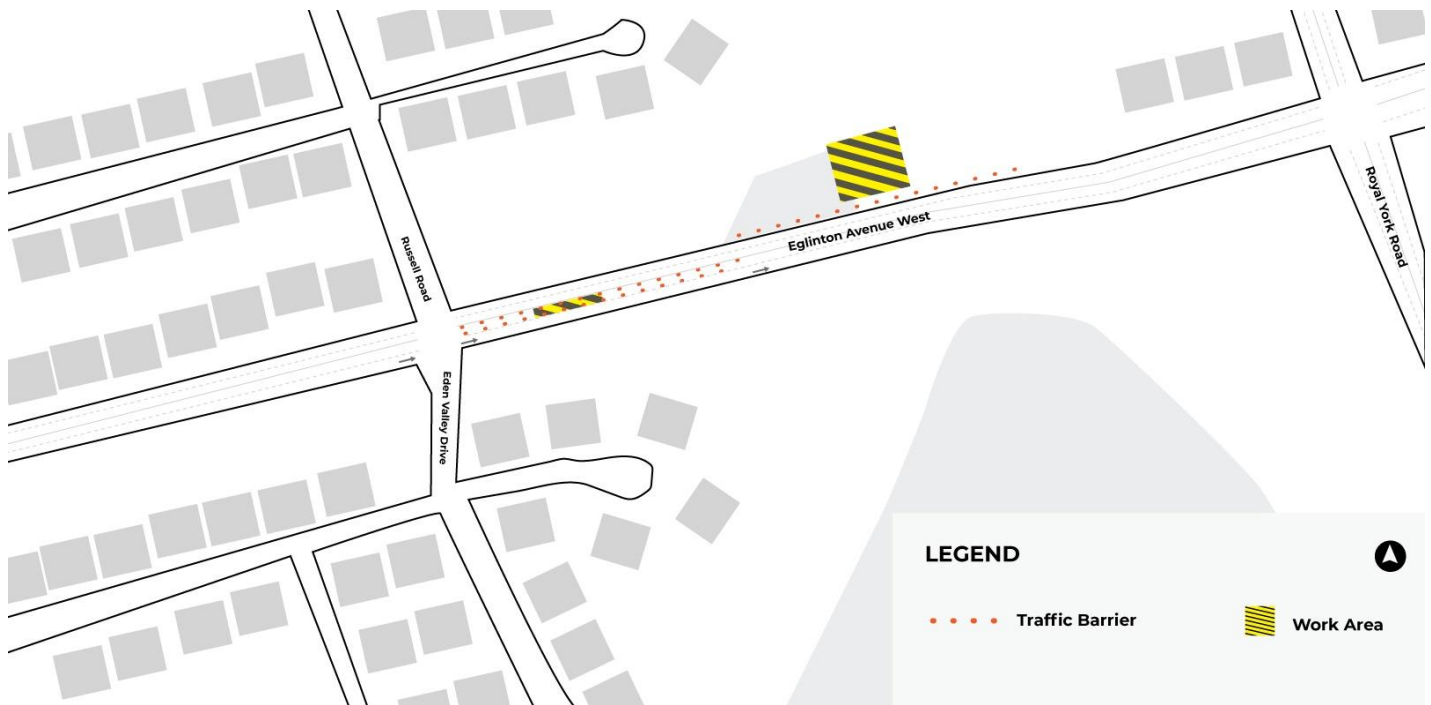

What is happening?

- As part of the subsurface investigation for the Eglinton Crosstown West Extension, crews working on behalf of Metrolinx will drill two boreholes approximately 20 - 30 metres deep, collect soil samples, and install groundwater monitoring wells to help measure water levels for planning and approvals.
- Crews will perform these works on the boulevard north of Eglinton Avenue West, and in the centre of the road east of Eden Valley Drive. See map for exact work areas.

What to expect

- Westbound traffic on Eglinton Avenue will be reduced to one lane east of Eden Valley Drive.
- Pedestrians will be diverted around the work zones as required.
- Fencing and traffic barrels will be used to separate the work zones.
- A hydro-vac truck will expose underground utilities to a depth of 3 meters before drilling begins.
- A small track mounted drill rig will be used for drilling.
- Crews may return to the work areas periodically over the next six months to collect water samples from the monitoring wells. Sampling will be for short durations (up to one hour).
- Water will be used during drilling to help control dust, and equipment will not idle unnecessarily.
- Once drilling is complete, the borehole will be filled and the ground restored. The work area will be cleaned, and any debris or soil will be removed.
- Work may be delayed or rescheduled due to weather conditions or unforeseen circumstances. Overnight or weekend work may be scheduled as needed.

Contact Us:

✉ Write to us at: EglintonWest@metrolinx.com

✂ Find us on X @[Metrolinx](#)

📷 Find us on Instagram @[MetrolinxToronto](#)

📘 Find us on Facebook @[Metrolinx Toronto](#)

☎ Call us at 416-202-8001

🌐 Visit the website: www.metrolinx.com/EglintonWest

- For more information on bus stop relocations on the northeast corner of Scarlett Road and Eglinton Avenue West, visit [metrolinx.com/eglintonwest_notices](https://www.metrolinx.com/eglintonwest_notices)

About the project

- The Eglinton Crosstown West Extension will bring even more rapid transit to Etobicoke and Mississauga, making it easier for people to get where they need to be each day.
- The extension of Line 5 Eglinton will run 9.2 kilometers from Mount Dennis Station to Renforth Drive. Once complete, it will create a continuous rapid transit line that stretches from Scarborough, through midtown Toronto, and into Mississauga.

Contact Us:

✉ Write to us at: EglintonWest@metrolinx.com

✂ Find us on X @[Metrolinx](https://twitter.com/Metrolinx)

📷 Find us on Instagram @[MetrolinxToronto](https://www.instagram.com/MetrolinxToronto)

f Find us on Facebook @[Metrolinx Toronto](https://www.facebook.com/MetrolinxToronto)

☎ Call us at 416-202-8001

🌐 Visit the website: www.metrolinx.com/EglintonWest