

# Ground and structural monitoring tools installation on Pape Avenue in the Sammon and Cosburn avenues Area

**Expected start date:** May 14, 2026

**Expected duration of works:** May 28, 2026

**Hours of Work:** Monday to Friday, 8 a.m. to 5 p.m. and 9 p.m. to 5 a.m.

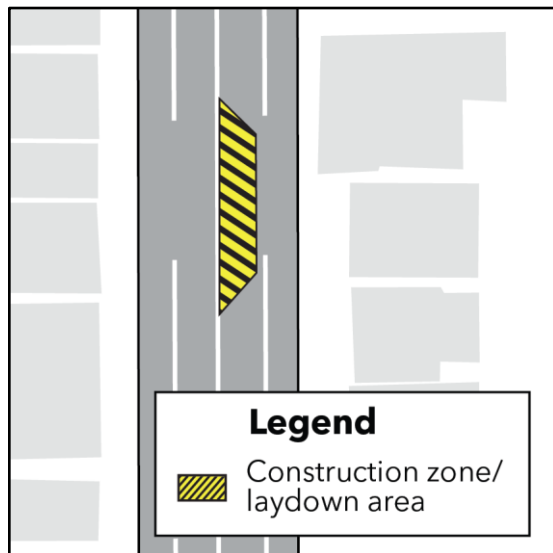

Typical four-lane road occupancy for equipment installation

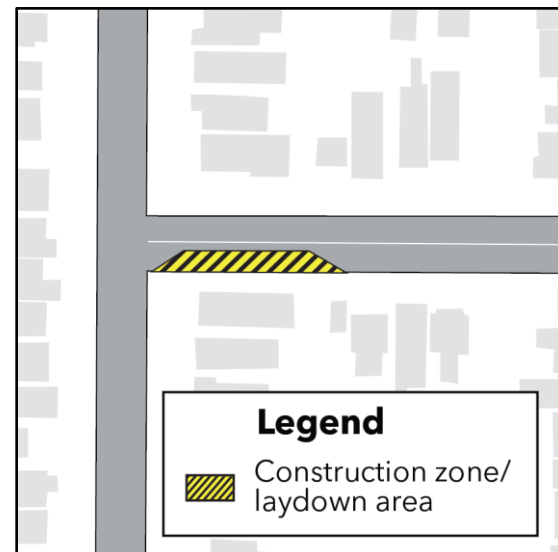

Typical two-lane, or one-way road occupancy for equipment installation

## What is happening?

- To support future Ontario Line construction activities, a geotechnical instrumentation monitoring program will be implemented along Pape Avenue and surrounding streets.
- Structural monitoring tools (instruments) will be placed within and close to our work sites and the future tunnels to help monitor and protect nearby structures.

## What to expect

- Work will take place from May 14, 2026, up until May 28, 2026, during weekdays between 8 a.m. to 5 p.m.
- Overnight work is required for a few days and will take place during weekdays between 9 p.m. to 5 a.m.
- Depending on the required tools (instrumentation), installation takes between one hour to three days.
- This work involves the use of a coring machine, hydrovac truck and a track-mounted drill rig.
- Work areas will be blocked off causing temporary impacts to pedestrian access, traffic lanes and on-street parking.
- Traffic control persons will be present during work hours and when construction vehicle movements require traffic or pedestrian control.
- During work activities near intersections, paid duty officers will be present to assist with pedestrian and vehicular traffic management.
- Throughout some phases of work, noise and dust from construction equipment is expected.
- Work may be postponed or rescheduled due to weather or unforeseen circumstances.
- For more information about upcoming work, please see [metrolinx.com/ontarioline](https://metrolinx.com/ontarioline) or sign up for the e-newsletter.

## About the Project

- 15.6-kilometre subway line that will make it faster and easier to travel within Toronto and beyond.
- 15 stops and more than 40 connections to other transit, including GO train, subway, LRT, streetcar, and bus lines.
- Less than 30 minutes from one end of the line to the other.
- 28,000 fewer cars on the road each day.

### Contact us:

Call us 24/7 at: [416-202-5100](tel:416-202-5100)

Write to us at: [ontarioline@metrolinx.com](mailto:ontarioline@metrolinx.com)

Find us on X, Facebook and Instagram: [@ontarioline](https://www.instagram.com/ontarioline)

Visit the website: [www.metrolinx.com/ontarioline](https://www.metrolinx.com/ontarioline)

### Visit our Danforth Avenue community office:

810 Danforth Ave., Toronto

- Monday-Friday 9 a.m. to 5 p.m.

### Or visit our other community offices:

- Riverside: 770 Queen St. E., Toronto
- Thorncliffe Park: 45 Overlea Blvd., Toronto

Disponible en français sur demande. Si vous êtes intéressé, veuillez envoyer un courriel à [ontarioline@metrolinx.com](mailto:ontarioline@metrolinx.com).