

# Borehole drilling near Eglinton Avenue West and Matheson Boulevard

Expected start: May 18, 2026

Expected completion: May 25, 2026

Work hours: Overnight between 6 p.m. - 6 a.m.

## Map of work area:

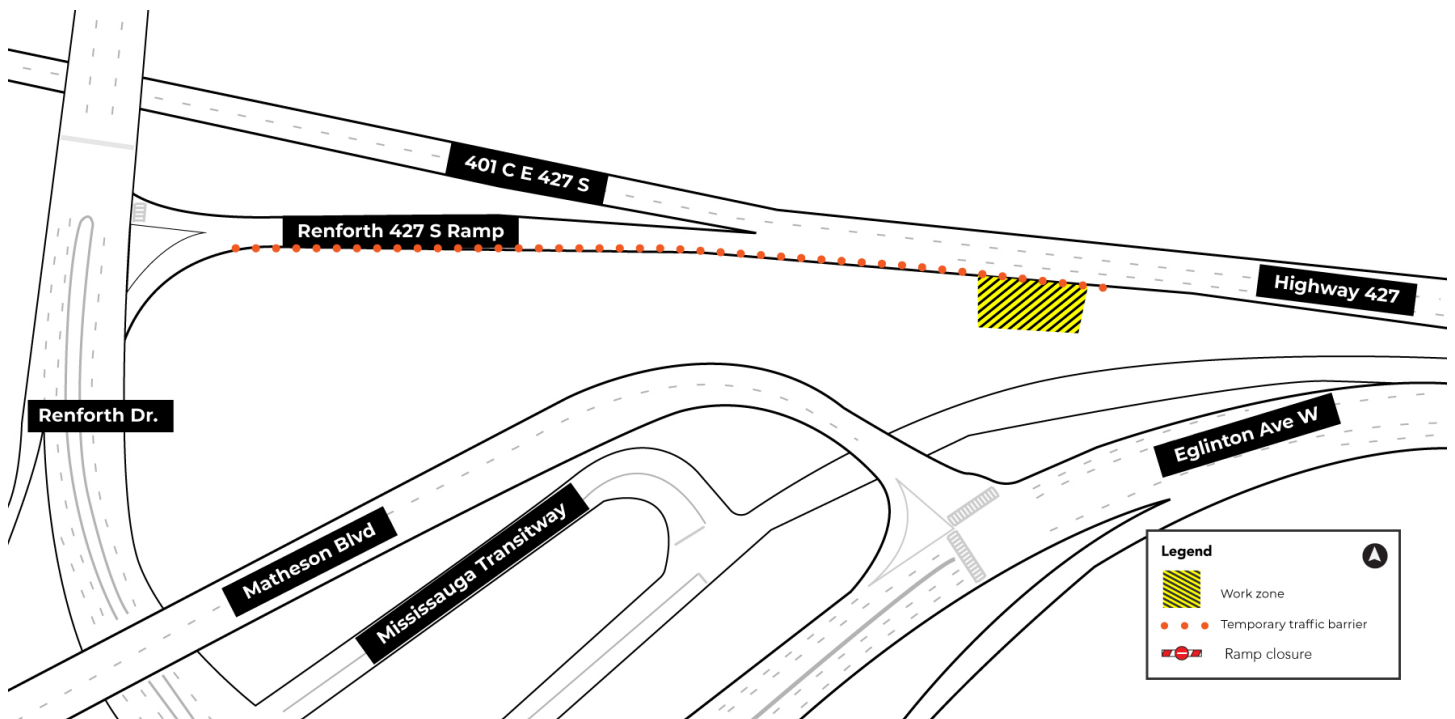

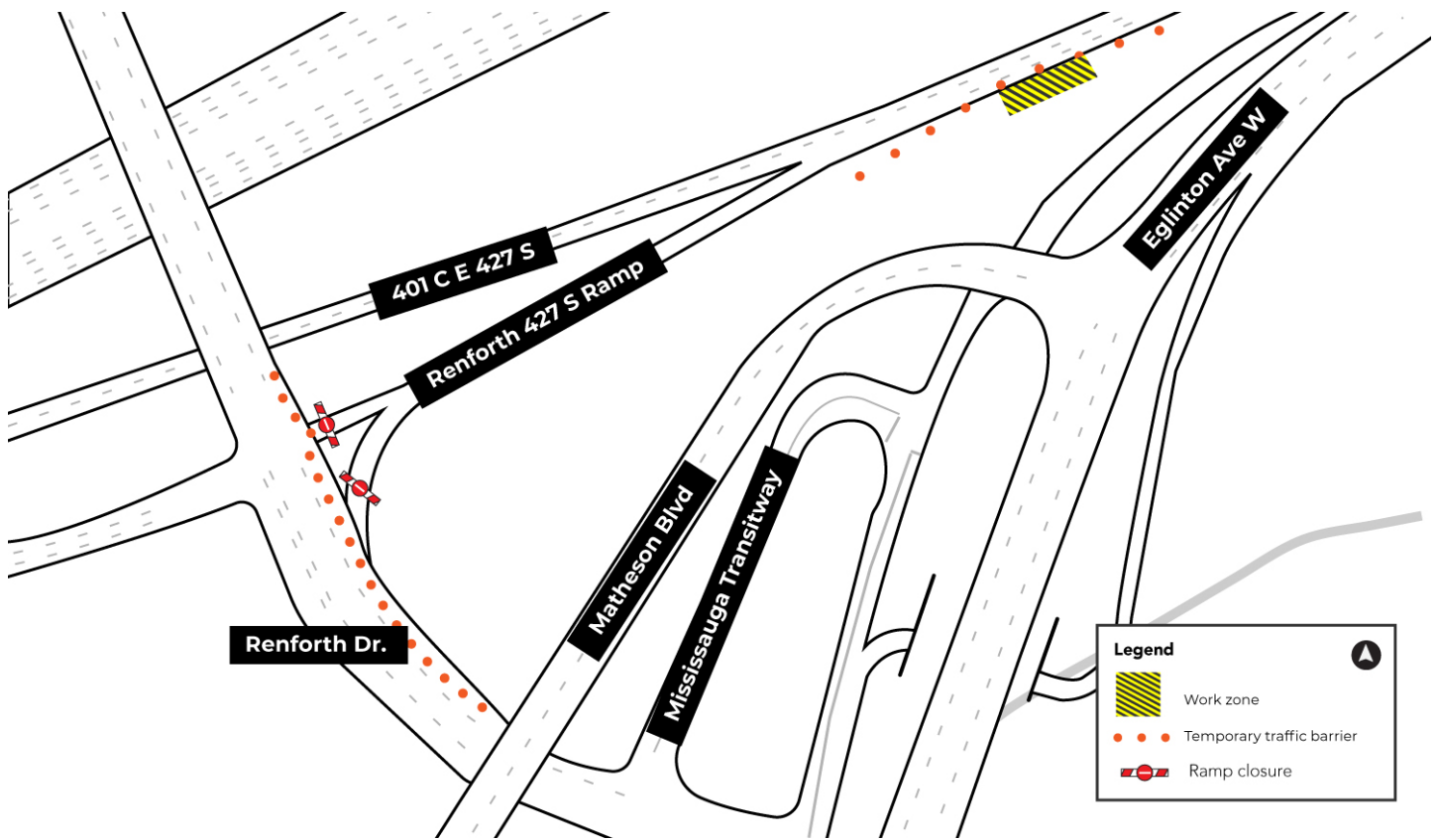

## What is happening?

- Crews working on behalf of Metrolinx will be drilling three boreholes approximately 40 metres deep, collecting soil samples and installing groundwater monitoring wells to help measure water levels as part of planning work for the Eglinton Crosstown West Extension.

## What to expect

- The Highway 427 on-ramp from Renforth Drive will be temporarily closed overnight between 11 p.m. - 5:30 a.m.
- This work is scheduled overnight to mitigate traffic delays.

### Contact Us:

✉ Write to us at: [EglintonWest@metrolinx.com](mailto:EglintonWest@metrolinx.com)

Find us on X @[Metrolinx](#)

📷 Find us on Instagram and [f](#) Facebook @[MetrolinxToronto](#)

☎ Call us at 416-202-8001

🌐 Visit the website: [www.metrolinx.com/EglintonWest](http://www.metrolinx.com/EglintonWest)

- Preparation work such as equipment mobilization and traffic set up will take place before and after the closure hours noted above.
- Fencing and temporary traffic barriers will be used to separate the work zones.
- A hydro-vac truck will expose underground utilities to a depth of three meters before drilling begins.
- A small track mounted drill rig will be used for drilling.
- Crews may return to the work areas periodically over the next six months to collect water samples from the monitoring wells. Sampling will be for short durations (up to one hour).
- Water will be used during drilling to help control dust and equipment will not idle unnecessarily.
- Once drilling is complete, the borehole will be filled and the ground restored. The work area will be cleaned, and any debris or soil will be removed.
- Work may be delayed or rescheduled due to weather conditions or unforeseen circumstances.

## About the project

- The Eglinton Crosstown West Extension will bring even more rapid transit to Etobicoke and Mississauga, making it easier for people to get where they need to be each day.
- The extension of Line 5 Eglinton will run 9.2 kilometers from Mount Dennis Station to Renforth Drive. Once complete, it will create a continuous rapid transit line that stretches from Scarborough, through midtown Toronto, and into Mississauga.

### Contact Us:

✉ Write to us at: [EglintonWest@metrolinx.com](mailto:EglintonWest@metrolinx.com)

Find us on X @[Metrolinx](#)

📷 Find us on Instagram and  Facebook [@MetrolinxToronto](#)

☎ Call us at 416-202-8001

🌐 Visit the website: [www.metrolinx.com/EglintonWest](http://www.metrolinx.com/EglintonWest)