

Borehole drilling near Eglinton Avenue and Highway 427

Expected start date: June 2, 2026

Expected completion: June 10, 2026

Work hours: Daytime between 9:00 a.m. to 4:00 p.m.

Map of Work Area

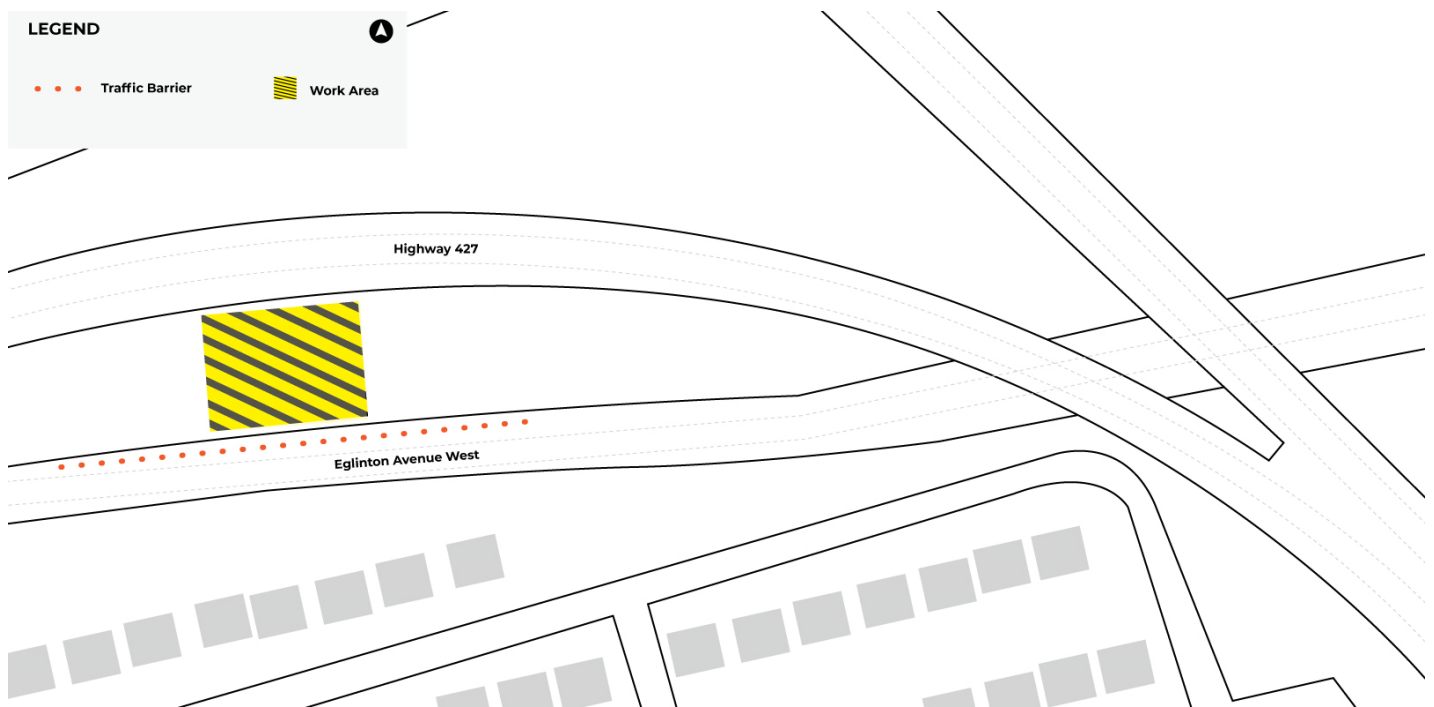

What is happening?

- As part of the subsurface investigation for the Eglinton Crosstown West Extension, crews working on behalf of Metrolinx will drill two boreholes approximately 20 - 40 metres deep, collect soil samples, and install groundwater monitoring wells to help measure water levels for planning and approvals.
- Crews will perform these works on the boulevard between of Eglinton Avenue West and Highway 427 (see map for exact work area).

What to expect?

- The westbound curb lane on Eglinton Avenue will be temporarily closed west of Highway 427 off-ramp.
- All TTC bus stops will remain open.
- Fencing and traffic barrels will be used to separate the work zones.
- A hydro-vac truck will expose underground utilities to a depth of 3 meters before drilling begins.
- A small track mounted drill rig will be used for drilling.
- Crews may return to the work areas periodically over the next six months to collect water samples from the monitoring wells. Sampling will be for short durations (up to one hour).
- Water will be used during drilling to help control dust, and equipment will not idle unnecessarily.
- Once drilling is complete, the borehole will be filled and the ground restored. The work area will be cleaned, and any debris or soil will be removed.
- Work may be delayed or rescheduled due to weather conditions or unforeseen circumstances. Overnight or weekend work may be scheduled as needed.
- For more information on bus stop relocations on the northeast corner of Scarlett Road and Eglinton Avenue West, visit [metrolinx.com/eglingtonwest_notices](https://www.metrolinx.com/eglingtonwest_notices)

About the project

- The Eglinton Crosstown West Extension will bring even more rapid transit to Etobicoke and Mississauga, making it easier for people to get where they need to be each day.
- The extension of Line 5 Eglinton will run 9.2 kilometers from Mount Dennis Station to Renforth Drive. Once complete, it will create a continuous rapid transit line that stretches from Scarborough, through midtown Toronto, and into Mississauga.

Contact Us:

✉ Write to us at: EglintonWest@metrolinx.com

✂ Find us on X @[@Metrolinx](https://twitter.com/Metrolinx)

📷 Find us on Instagram @[@MetrolinxToronto](https://www.instagram.com/MetrolinxToronto)

📘 Find us on Facebook @[@Metrolinx Toronto](https://www.facebook.com/MetrolinxToronto)

☎ Call us at 416-202-8001

🌐 Visit the website: www.metrolinx.com/EglintonWest