

# Temporary sidewalk realignment at 805 Don Mills Road

**Scheduled Start Date:** May 13, 2026

**Scheduled End Date:** May 29, 2026

**Working Hours:** Monday to Friday, 7:35 a.m. to 7:00 p.m.

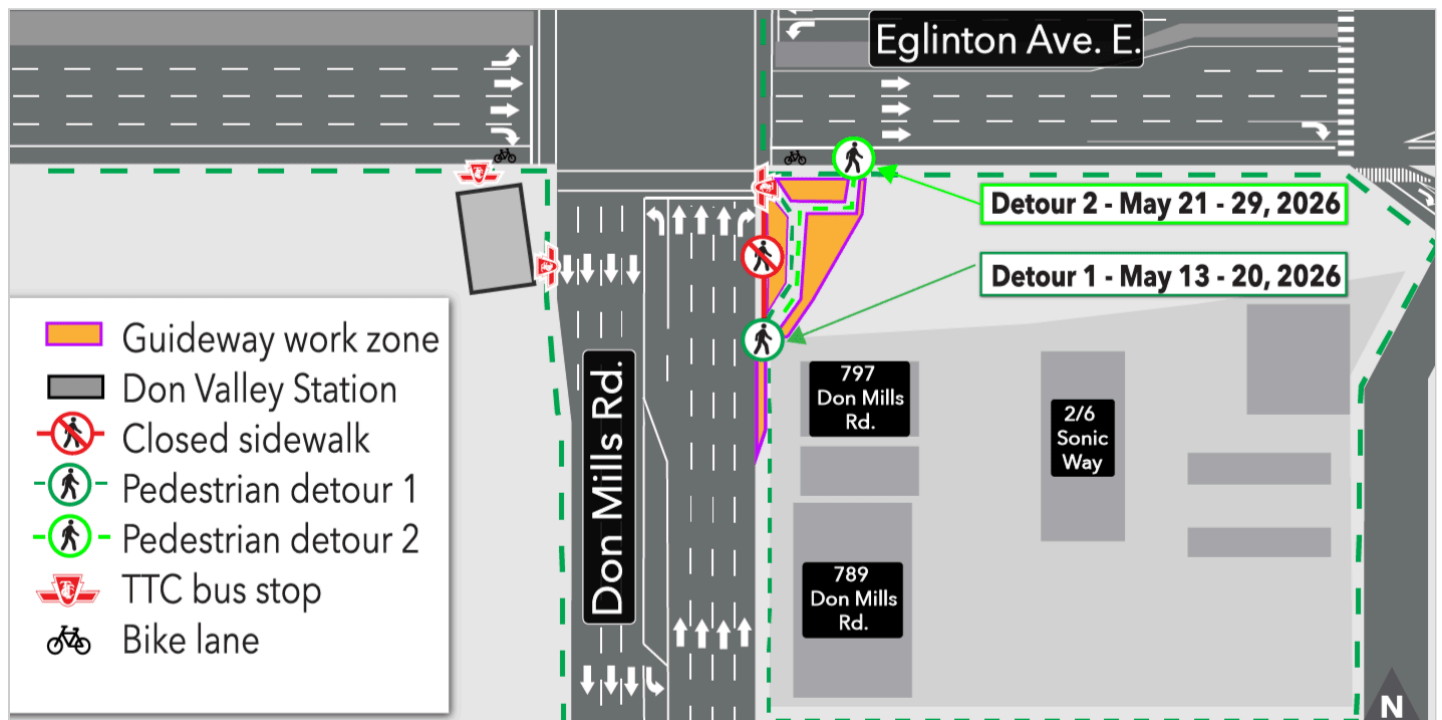

## Sidewalk realignment at southeast corner of Don Mills Road and Eglinton Avenue East

### What Is Happening?

- Starting as early as May 8, 2026, traffic crews will close a portion of the sidewalk along the east side of Don Mills Road between Eglinton Avenue East and 797 Don Mills Road. Crews will create a pedestrian detour that will realign the sidewalk into 805 Don Mills Road site providing continued access to the intersection at Don Mills Road and Eglinton Avenue East.
- Pedestrian detour 1 will be set up as early as May 13, 2026 until May 20, 2026 and will provide continued pedestrian access along the east side of Don Mills Road.
- Pedestrian detour 2 will begin as early as May 21, 2026 until May 29, 2026 and will provide pedestrian access to Don Mills Road via an access ramp at Eglinton Avenue East.
- Advance signage will inform pedestrians of the realigned detour and fencing will separate the pathway from the construction site.

## What to Expect?

- Trucks and construction equipment may generate dust during construction.
- Crews will take precautions to monitor and reduce dust.
- Increased presence of construction vehicles and equipment can be expected in the work area.
- Work areas will be clearly marked or fenced off to ensure public safety.
- Please exercise caution around active construction sites.
- Work may be delayed or rescheduled due to weather or unforeseen circumstances.
- Trucks will stage inside the work site and will not stage outside of the site boundaries
- Mud mats and a wheel wash system are installed to prevent debris from being tracked onto public roads.

## Traffic Changes

- Minor delays may be experienced near the work zone.
- All businesses in the area will remain open during the work. Please follow signage for access.

## Pedestrian Access

- Temporary sidewalk closures or pedestrian detours will be in place while the work is underway, with signs in place to direct pedestrians as needed.
- Pedestrian detours may be required, with signs in place to direct pedestrians as needed.
- Clear and defined walking paths will be maintained during construction to ensure pedestrian safety.

## Noise & Vibration

- Residences and businesses in the area may experience noise and vibration caused by construction equipment related to this work.
- Crews will take measures to minimize disruptions to the surrounding area wherever possible.
- To minimize noise impacts on the community, noise and vibration monitoring equipment will be installed prior to construction. These devices will help to detect exceedances early to proactively conduct corrective actions as needed while crews work.

## Transit Service

- There is no anticipated impact to transit services.

---

## About the Project

A new 15.6-km subway line with 15 stops and 40+ transit connections that delivers end-to-end trips in under 30 minutes while taking 28,000 cars off Toronto's roads each day.

### Questions? We're here for you.

- 🌐 <https://www.metrolinx.com/ontario-line>
- ✉ [ontarioline@metrolinx.com](mailto:ontarioline@metrolinx.com)
- 📱 [@ontarioline](#)
- 📞 4162025100

### Visit our community offices:

- 📍 45 Overlea Blvd., Toronto, ON
- 📍 770 Queen St. E., Toronto, ON
- 📍 810 Danforth Ave., Toronto, ON