

Ground investigations at Thickson Road South

Scheduled Start Date: June 15, 2026

Scheduled End Date: July 24, 2026

Working Hours: Monday to Friday, 7:00 a.m. to 5:00 p.m. and 8:00 p.m. to 6:00 a.m.

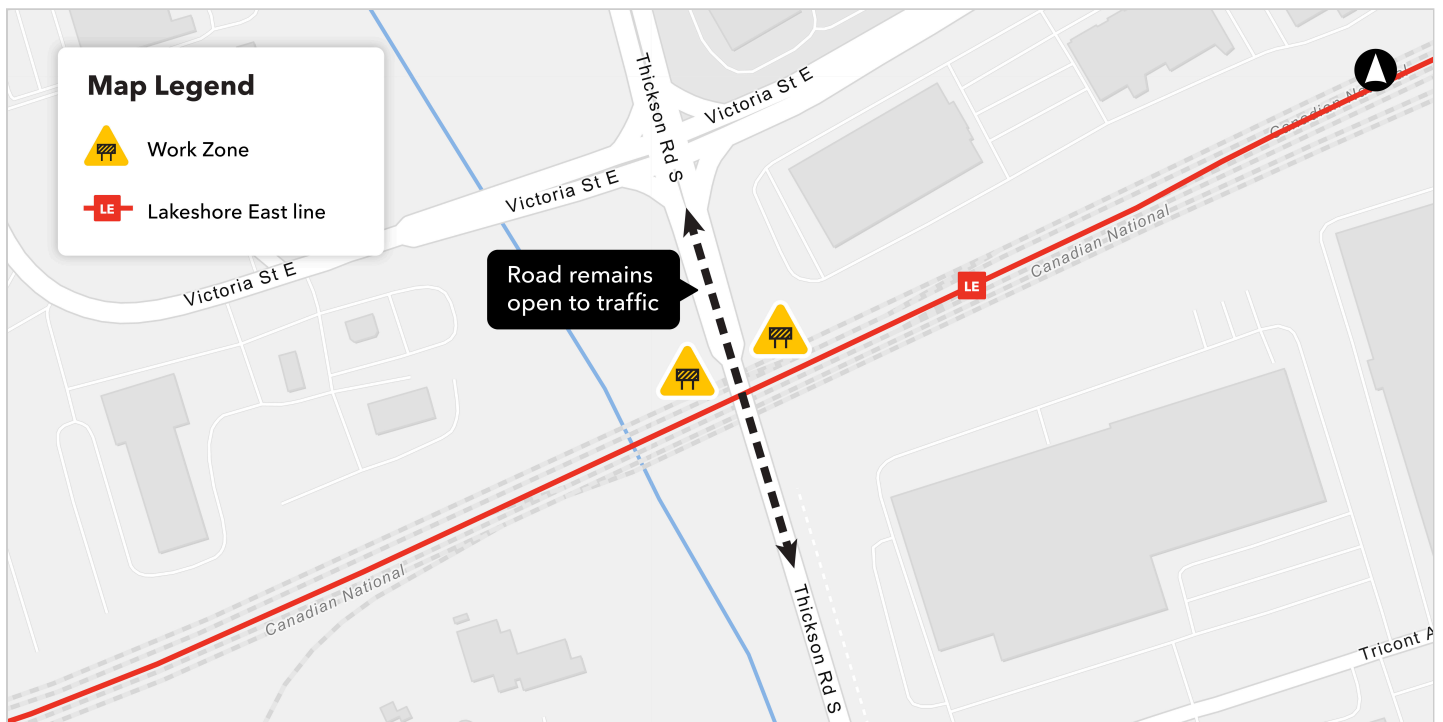

Approximate locations of ground investigation work at Thickson Road South

What Is Happening?

We will be carrying out ground and utility investigations in the locations shown on the map, near the railway bridge at Thickson Road S. Crews will occupy single lanes at the Thickson Road bridge in temporary lane closures - please note the road will not be fully closed, bidirectional traffic will be maintained at all times.

What to Expect?

- Construction lighting may be visible from the work site.
- Trucks and construction equipment may generate dust during construction.
- Increased presence of construction vehicles and equipment can be expected in the work area.
- Work areas will be clearly marked or fenced off to ensure public safety.
- Please exercise caution around active construction sites.
- Work may be delayed or rescheduled due to weather or unforeseen circumstances.

Traffic Changes

- Two-way directional traffic will be maintained during the work.

Pedestrian Access

- Clear and defined walking paths will be maintained during construction to ensure pedestrian safety.

Noise & Vibration

- Residences and businesses in the area may experience noise and vibration caused by construction equipment related to this work.

Transit Service

- There is no anticipated impact to transit services.
-

About the Project

GO Expansion will bring faster, more frequent train service by delivering new transit infrastructure and operational plans that will reduce journey times, add capacity and further improve on-time performance and customer satisfaction. The goal is to create a network with the capacity to deliver service every 15 minutes or better, all-day in both directions on core routes across the GO rail network.

Questions? We're here for you.

<https://www.metrolinx.com/en/projects-and-programs/lakeshore-west-line-go-expansion>

durhamregion@metrolinx.com

[@MetrolinxDurham](#)

[@Metrolinx](#)

416-202-3900